

Mini Sollerman Test



Instruction manual

Thank you for purchasing the Mini Sollerman Test

The mini Sollerman Test is manufactured out of polyoxymethylen (POM). POM is characterized by excellent material properties in respect to strength, hardness and stiffness.

The mini Solleman Test meets all the provisions of the directive 93/42/EEC (or 90/385/EEC) which apply to it.

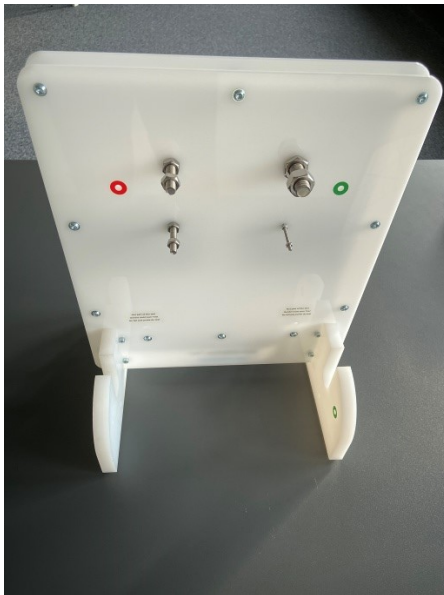

Maintenance/Cleaning: to clean the mini Sollerman Test, we recoment to spray the test with a non-abrasive solution of water and soap and dry it with a soft cloth.

Do you have any questions?

Contact us per email: info@sensory-test.com

The instruction manual is based on the „National Assessment Manual for assessment of hand function after nerve repair“ of the HAKIR



Material needed to administer the test:

Mini Sollerman-Test

- Subtests 4, 8 and 10

Stop watch

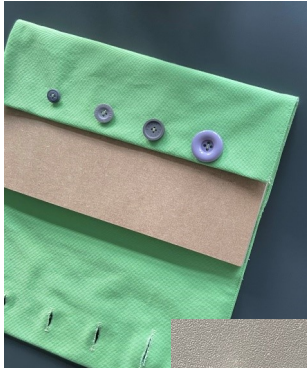

The standardized Sollerman test contains 20 tasks based on the most common types of grip. Studies including patients with nerve injuries (median or ulnar nerve injuries) have shown that the results from 3 of the 20 tasks (4, 8 and 10) correlate strongly with the results from the full test with 20 tasks.

Selected parts of the Sollerman hand function test (tasks 4, 8 and 10) are therefore included in the Mini Sollerman test, and are performed in accordance with the original instructions. The results of the mini Sollerman test are needed to calculate the Rosén Score.

Preparation:

To prepare the three selected tasks from the Sollerman test, place two coins inside each purse of task 4 and keep the zippers open, unscrew all four bolts in task 8 and place them on the table. For task 10, undo all four buttons. .

Test procedure:

The test results are initially inserted into the raw-data protocol.

Each test is times and performed in the following order: 4, 8, 10.

The patient is seated at a table and the test is placed in front of him/her.

The patient starts with each task when you say “start”

Optional choice of grip. Maximum time is 60 seconds.

Scoring:

Points	Definition
4	The task was completed without any difficulty within 20s and the prescribed hand grip of normal quality. .
3	The task was completed, but with slight difficulty or the task was not completed within 20s, but within 40s or the task was completed with the prescribed hand grip with slight divergence from normal
2	The task was completed, but with great difficulty or the task was not completed within 40s, but within 60s or the task was not completed with the prescribed hand grip with slight divergence from normal
1	The task was only partially performed within 60s
0	The task could not be performed at all within 60s

Quantification in Rosen score:

The quotient between the total score achieved (0-12) and the normal (12) score is calculated and inserted into the box marked "Score Sollerman test" in the Sensory domain.

For the administration of the mini Sollerman test three types of hand grips are used:

Pulp pinch:

The object is held between the thumb and the index and/or middle finger.

Tripod/Chuck pinch:

The object is surrounded by the thumb, the index finger, and the middle finger. It may have (but need not have) contact with the web of the thumb.

Lateral pinch:

The object is held between the thumb and the radial side of the index finger.

Pulp pinch



Tripod/chuck pinch



Lateral pinch

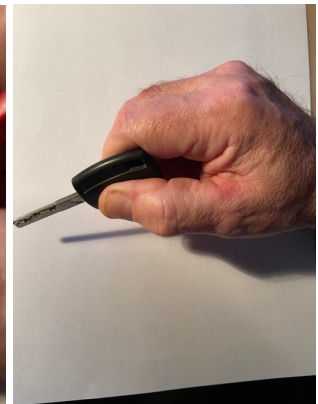

Task 4:

“Pick up the coins (optional order), one at a time from the open purses and place them on the table”

Hand grip: Pulp pinch.



Task 8:

“Pick up the screw-nuts from the table, one at a time (optional order), and put them on the appropriate bolts”. (just so that they stay there).

Hand grip: Pulp pinch, Lateral pinch, Tripod chuck pinch

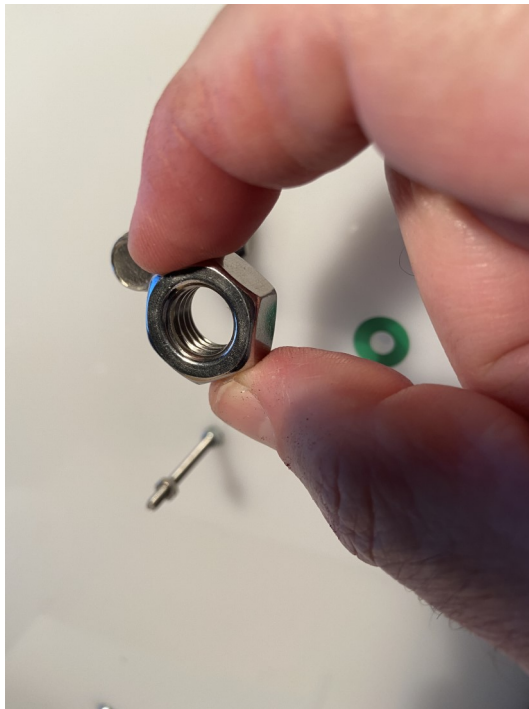

Task 10:

Position the buttons in front of the patient (see photograph). It is optional whether the biggest button is “op” or “down”. ***“Button the four buttons (optional order) with one hand You are allowed to stabilize the equipment with the untested hand”***

Hand grips: Pulp pinch, Lateral pinch



Test assembly



Step 1: Remove the two wing nuts

Step 2: Remove the two knob-screws

Step 3: Slide the long plate of the test in the slit of the feet, between the spacers

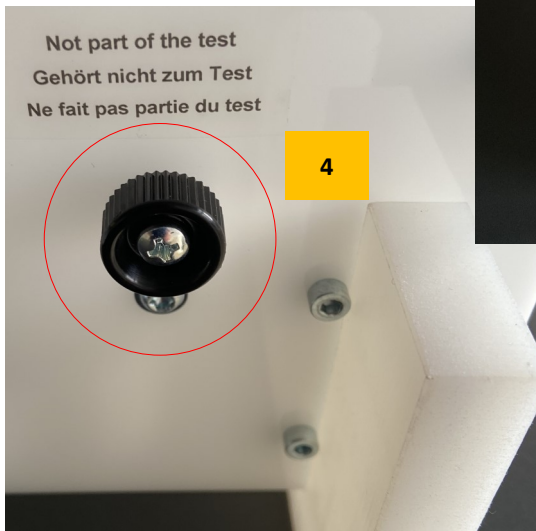
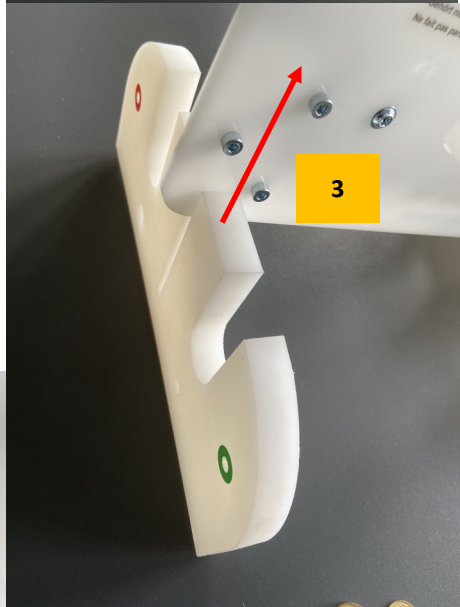
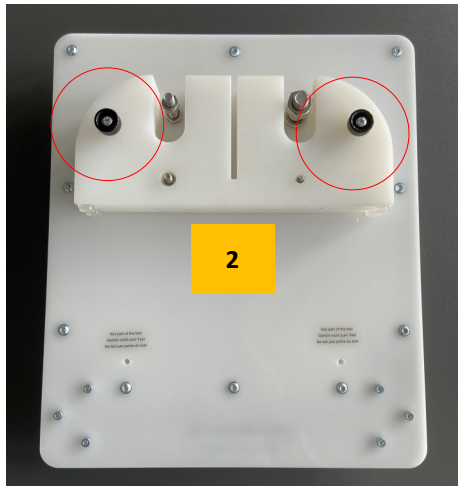

Step 4: the knob screw and wing nut can be stored in the two holes at the bottom of the test

Test disassembly

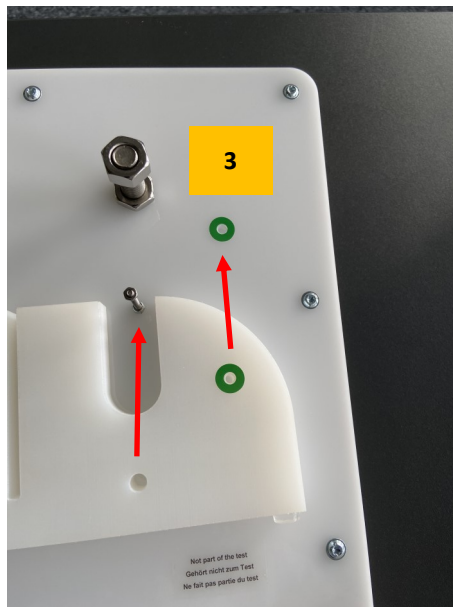
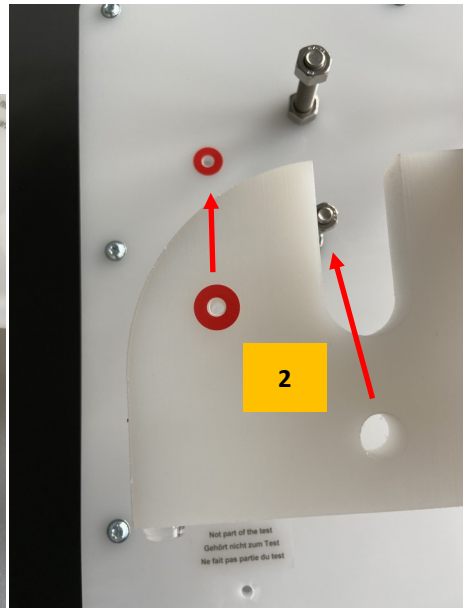
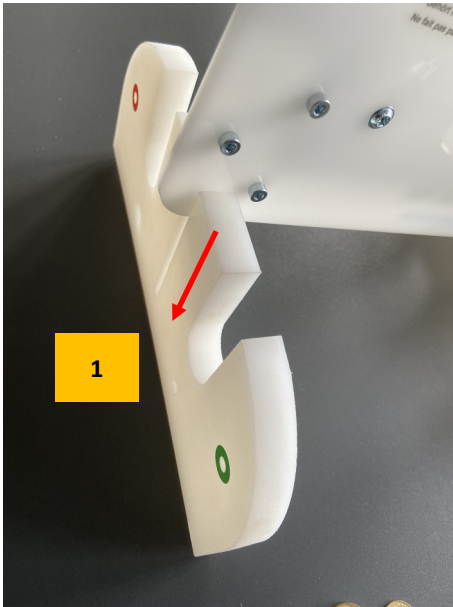

Step 1: remove both feet by pulling them out straight

Step 2: place the red rings on top of each other.

Step 3: place the green rings on top of each other.

(The feet will protect the smaller screws during storage)

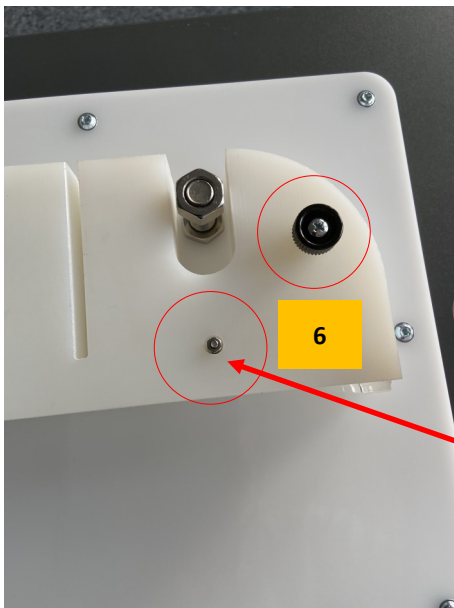
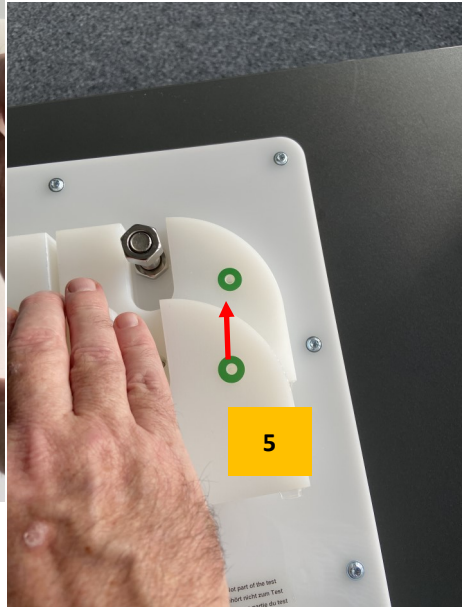
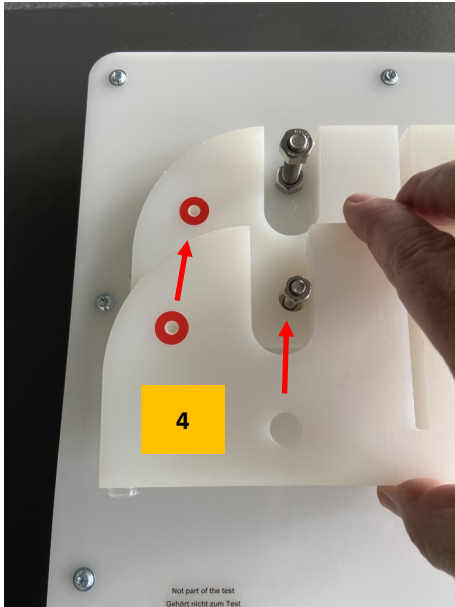

Step 4: remove both feet by pulling them out straight

Step 5: place the red rings on top of each other.

Step 6: place the green rings on top of each other.

Smallest screw needing to be protected.